



VISTA+

Counters

VISTA+





Few design solutions manage to combine flexibility, style and functionality successfully, three very important requirements in modern educational furniture design. **Vista+** counters by British Thornton is the exception, offering a highly desirable range of modular counters ideally suited to libraries, receptions or breakout areas. This extensive range is easy to configure and is ideal for creating functional and striking reception counters with the option to integrate power and data supply for IT use. The **Vista+** range of counters is offered in a wide selection of colour and material options to suit your scheme and budget. If you require help planning your counter, we offer a free planning and design service.

The **Vista+** range of counters features high quality, high gloss, solid acrylic panels; which are available in eight bold contemporary colours. The body of the units are white or light grey as standard.



All of the reception counter units in the Vista+ range are modular and available as starters, extensions, end units and where possible wheelchair accessible counters. This allows your counter to have a continuous work area without the inconvenience of support panels. Each unit is delivered fully assembled (access permitting) and the counters simply 'clip' together with very minimal fixing.

Each counter unit has a matching top box which are specified independently, as separate items. This allows you to create your counter, as you require it without compromise.

Cable management is provided by cable ports in the counter tops and access holes from one counter unit to another. Cable ports can be substituted for power and data modules if required. Additional horizontal cable management can be integrated into the units upon request.



**Counters**

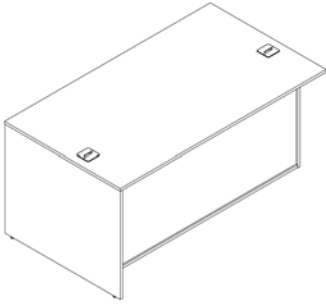

**Straight Starter**

VRCSS10\*-\*\*  
1000(w) x 900(d) x 760(h)mm  
VRCSS12\*-\*\*  
1200(w) x 900(d) x 760(h)mm  
VRCSS14\*-\*\*  
1400(w) x 900(d) x 760(h)mm  
VRCSS16\*-\*\*  
1600(w) x 900(d) x 760(h)mm

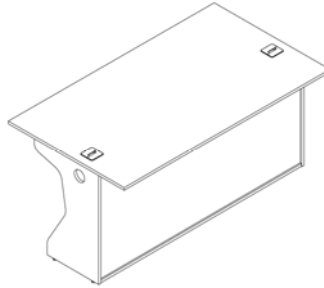

**Straight Mid**

VRCSM10\*-\*\*  
1000(w) x 900(d) x 760(h)mm  
VRCSM12\*-\*\*  
1200(w) x 900(d) x 760(h)mm  
VRCSM14\*-\*\*  
1400(w) x 900(d) x 760(h)mm  
VRCSM16\*-\*\*  
1600(w) x 900(d) x 760(h)mm

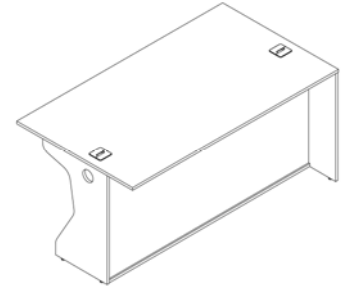

**Straight End**

VRCSE10\*-\*\*  
1000(w) x 900(d) x 760(h)mm  
VRCSE12\*-\*\*  
1200(w) x 900(d) x 760(h)mm  
VRCSE14\*-\*\*  
1400(w) x 900(d) x 760(h)mm  
VRCSE16\*-\*\*  
1600(w) x 900(d) x 760(h)mm

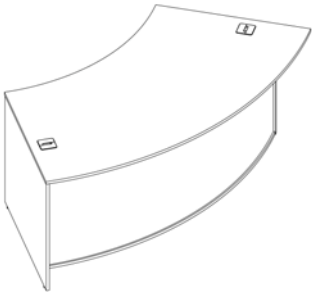

**60° Outer Curved Starter**

VRCCS60\*-\*\*  
2100(w) x 900(d) x 760(h)mm

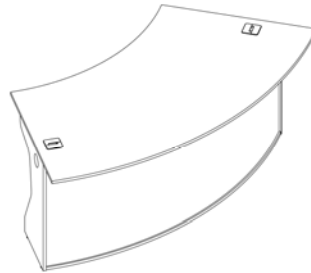

**60° Outer Curved Mid**

VRCCM60\*-\*\*  
2100(w) x 900(d) x 760(h)mm

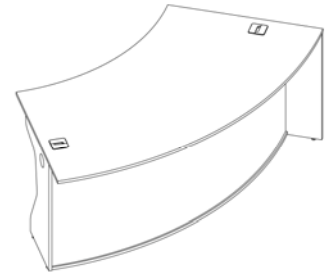

**60° Outer Curved End**

VRCCE60\*-\*\*  
2100(w) x 900(d) x 760(h)mm

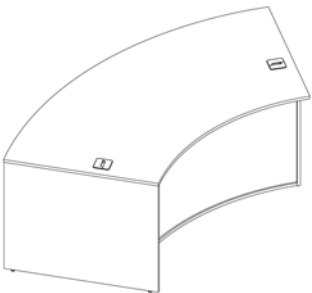

**60° Inner Curved Starter**

VRCCS61\*-\*\*  
2100(w) x 900(d) x 760(h)mm

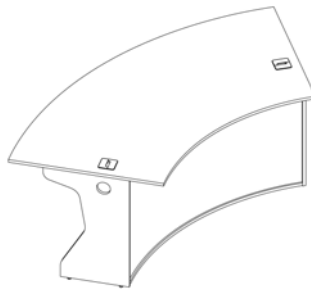

**60° Inner Curved Mid**

VRCCM61\*-\*\*  
2100(w) x 900(d) x 760(h)mm

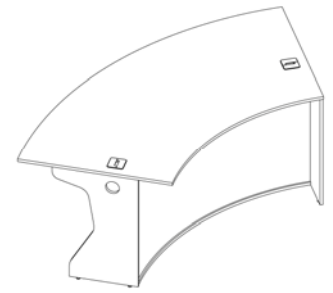

**60° Inner Curved End**

VRCCE61\*-\*\*  
2100(w) x 900(d) x 760(h)mm

Please remember to suffix the product codes with the body finish and acrylic finish as required. See finishes page for details.

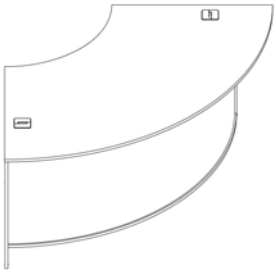

**90° Outer Curved Starter**  
VRCCS90\*-\*\*  
2121(w) x 900(d) x 760(h)mm

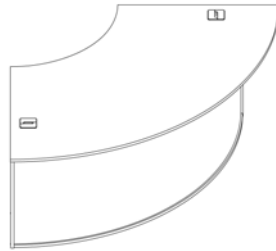

**90° Outer Curved Mid**  
VRCCM90\*-\*\*  
2121(w) x 900(d) x 760(h)mm

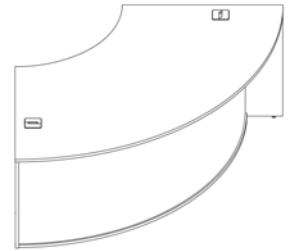

**90° Outer Curved End**  
VRCCE90\*-\*\*  
2121(w) x 900(d) x 760(h)mm

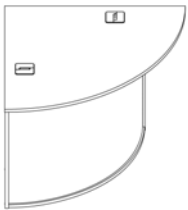

**90° Compact Curved Mid**  
VRCCM91\*-\*\*  
1272(w) x 900(d) x 760(h)mm

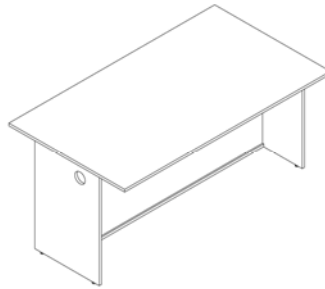

**Straight DDA**  
VRCSD10\*-\*\*  
1000(w) x 900(d) x 760(h)mm  
VRCSD12\*-\*\*  
1200(w) x 900(d) x 760(h)mm  
VRCSD14\*-\*\*  
1400(w) x 900(d) x 760(h)mm  
VRCSD16\*-\*\*  
1600(w) x 900(d) x 760(h)mm

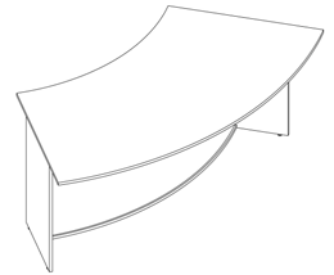

**60° Outer Curved DDA**  
VRCCD60\*-\*\*  
2100(w) x 900(d) x 760(h)mm

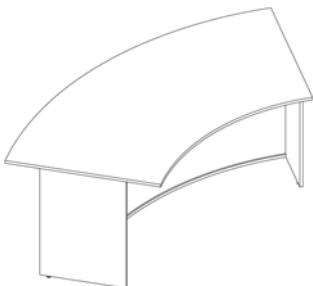

**60° Inner Curved DDA**  
VRCCD61\*-\*\*  
2100(w) x 900(d) x 760(h)mm

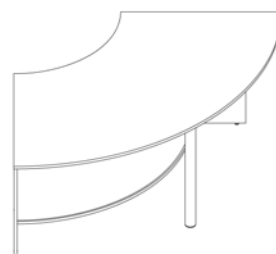

**90° Outer Curved DDA**  
VRCCD90\*-\*\*  
2121(w) x 900(d) x 760(h)mm

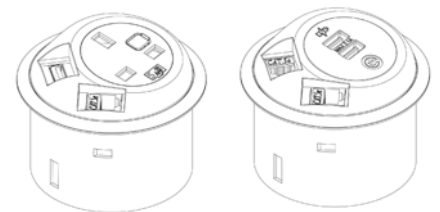

**VTP1**  
Power Unit.  
1x power, 1x USB, 1x data  
3m Mains power lead  
3m CAT5e UTP flyleads

**VTP2**  
Power Unit.  
2x fast charge USB, 2x data  
3m CAT5e UTP flyleads

Please remember to suffix the product codes with the body finish and acrylic finish as required. See finishes page for details.



## Top Boxes

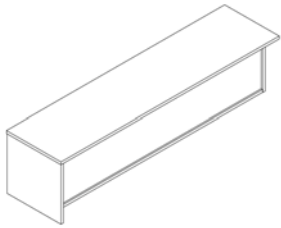

### Straight Starter

VRTSS10\*-\*\*

1000(w) x 400(d) x 400(h)mm

VRTSS12\*-\*\*

1200(w) x 400(d) x 400(h)mm

VRTSS14\*-\*\*

1400(w) x 400(d) x 400(h)mm

VRTSS16\*-\*\*

1600(w) x 400(d) x 400(h)mm

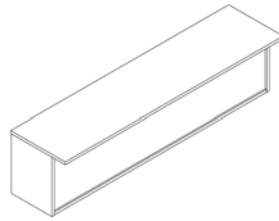

### Straight Mid

VRTSM10\*-\*\*

1000(w) x 400(d) x 400(h)mm

VRTSM12\*-\*\*

1200(w) x 400(d) x 400(h)mm

VRTSM14\*-\*\*

1400(w) x 400(d) x 400(h)mm

VRTSM16\*-\*\*

1600(w) x 400(d) x 400(h)mm

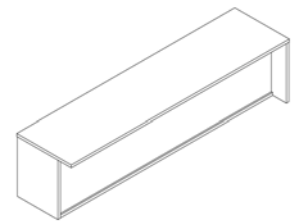

### Straight End

VRTSE10\*-\*\*

1000(w) x 900(d) x 760(h)mm

VRTSE12\*-\*\*

1200(w) x 900(d) x 760(h)mm

VRTSE14\*-\*\*

1400(w) x 900(d) x 760(h)mm

VRTSE16\*-\*\*

1600(w) x 900(d) x 760(h)mm

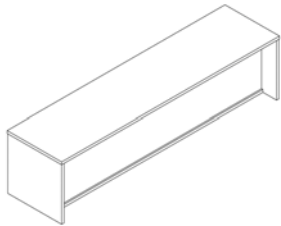

### Straight Stand Alone

VRTSU10\*-\*\*

1000(w) x 900(d) x 760(h)mm

VRTSU12\*-\*\*

1200(w) x 900(d) x 760(h)mm

VRTSU14\*-\*\*

1400(w) x 900(d) x 760(h)mm

VRTSU16\*-\*\*

1600(w) x 900(d) x 760(h)mm

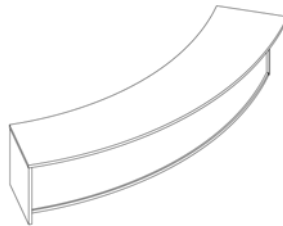

### 60° Outer Curved Starter

VRTCS60\*-\*\*

2000(w) x 400(d) x 400(h)mm

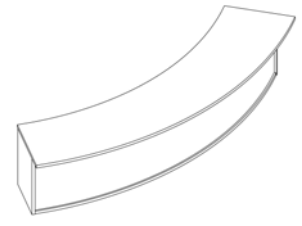

### 60° Outer Curved Mid

VRTCM60\*-\*\*

2000(w) x 400(d) x 400(h)mm

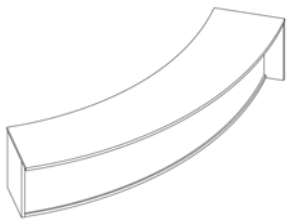

### 60° Outer Curved End

VRTCE60\*-\*\*

2000(w) x 400(d) x 400(h)mm



### 60° Outer Curved Stand Alone

VRTCU60\*-\*\*

2000(w) x 400(d) x 400(h)mm

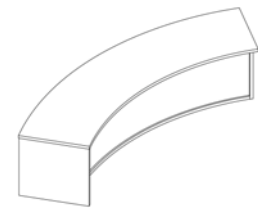

### 60° Inner Curved Starter

VRTCS61\*-\*\*

1700(w) x 400(d) x 400(h)mm

Please remember to suffix the product codes with the body finish and acrylic finish as required. See finishes page for details.



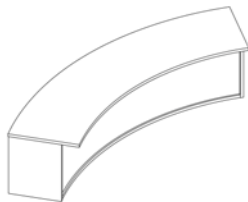

**60° Inner Curved Mid**  
VRTCM61\*<sup>-\*\*</sup>  
1700(w) x 400(d) x 400(h)mm

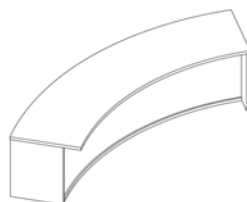

**60° Inner Curved End**  
VRTCE61\*<sup>-\*\*</sup>  
1700(w) x 400(d) x 400(h)mm



**60° Inner Curved Stand Alone**  
VRTCU61\*<sup>-\*\*</sup>  
1700(w) x 400(d) x 400(h)mm

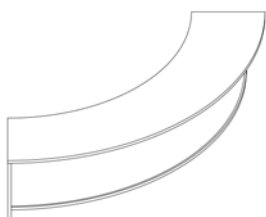

**90° Outer Curved Starter**  
VRTCS90\*<sup>-\*\*</sup>  
1980(w) x 400(d) x 400(h)mm



**90° Outer Curved Mid**  
VRTCM90\*<sup>-\*\*</sup>  
1980(w) x 400(d) x 400(h)mm



**90° Outer Curved End**  
VRTCE90\*<sup>-\*\*</sup>  
1980(w) x 400(d) x 400(h)mm



**90° Outer Curved Stand Alone**  
VRTCU90\*<sup>-\*\*</sup>  
1980(w) x 400(d) x 400(h)mm



**90° Compact Curved Mid**  
VRTCM91\*<sup>-\*\*</sup>  
1980(w) x 400(d) x 400(h)mm

### Standard finishes

Counter bodies are available in 2 standard finishes as standard.



White 8100 / Light Grey 6466

### Acrylic finishes

Acrylic panels and screens are available in 8 standard finishes.



Lime / Citrus Orange / Hot Pink / Dark Cyan / Aubergine / Zest Yellow / Grey / Alpine White

*Code suffixes are shown inside colour swatches.*

### Warranty

The modern teaching environment places heavy demands on furniture and fittings, so we build quality and durability into everything we produce. Proof of our commitment to the highest standards is our 5 year warranty on all products in the **Vista+** range, subject to fair wear and tear.

### Environment

All of our timber is responsibly sourced from FSC or PEFC accredited suppliers.

We heat our factory using waste wood and sawdust.

Our products are lovingly wrapped in blankets during transportation; reusable and no waste packaging.

We recycle 100% of our general waste.

We are ISO 14001 accredited.

All of the products we manufacture are FSC and PEFC certified.

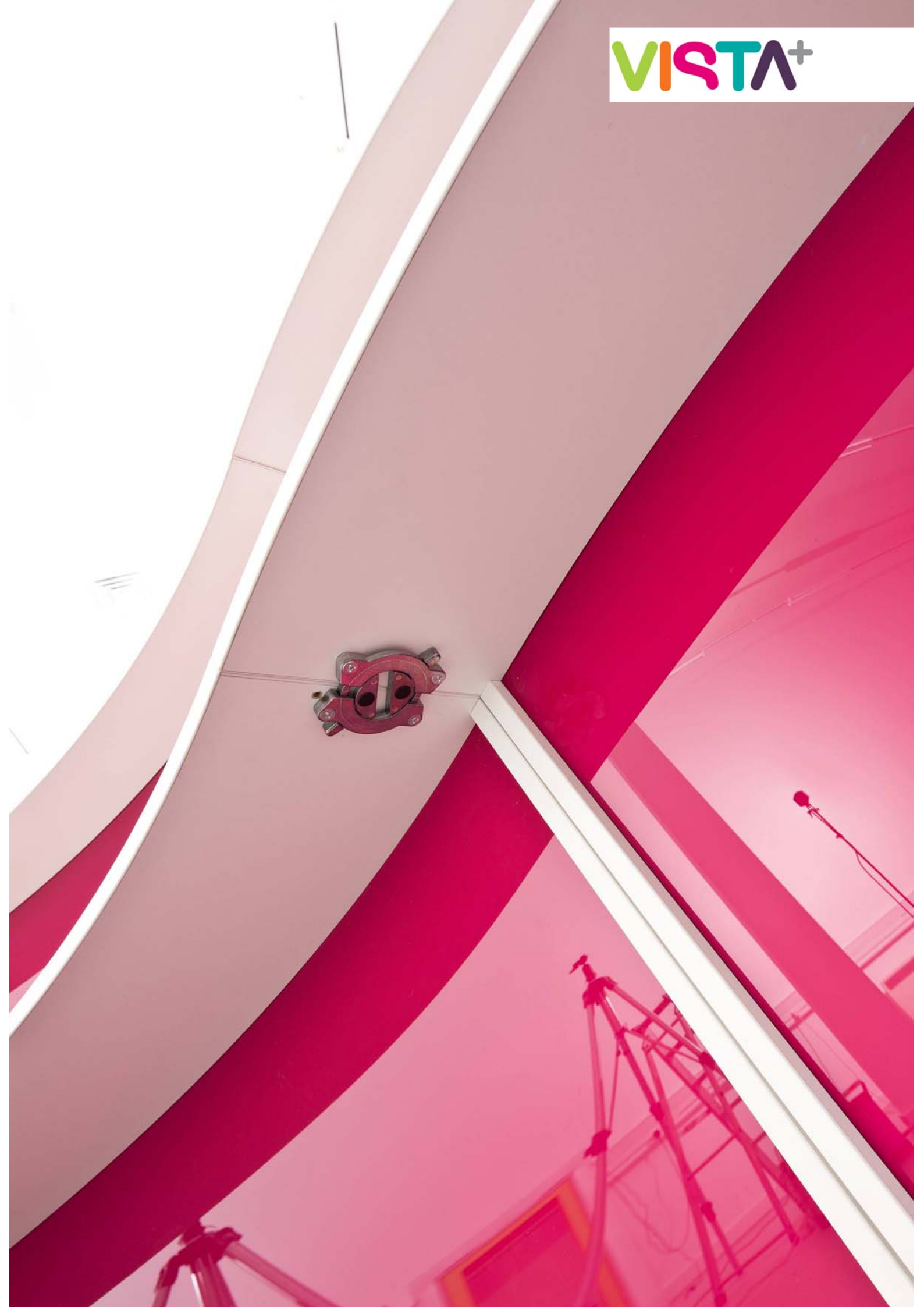



British Thornton ESF Ltd, Prospect Works, South Street, Keighley, West Yorkshire, BD21 5AA

Tel: 08705 329 201 | Fax: 01535 680 226 | Email: [sales@british-thornton.co.uk](mailto:sales@british-thornton.co.uk) | Web: [www.british-thornton.co.uk](http://www.british-thornton.co.uk)