

BRITISH THORNTON

Uniclass	EPIC		
L8511	Q511		
CI/SfB			
732	(72)	X	



laboratory
systems



furniture



quality & service

Calling on over 130 years' experience our promise to you is the design, production and installation of quality tailor-made laboratory furniture to the highest specifications.

In addition, you will benefit from the advice and expertise of a talented and experienced project management team - ensuring your installation is fully co-ordinated, exactly matching your requirements **and** your budget

British Thornton's continued and growing presence within the laboratory design and furnishing market is, we believe, testament to our exceptional levels of customer service and satisfaction. **Call us, and see for yourself!**

British Thornton is independently owned and managed by its three directors - and trades from a strong financial position, providing the double benefits of a market-leading organisation with real buying strength and experience, coupled with a hands on, customer focussed, management style and training ethos.

Design
Bespoke Furniture

Content

- Genesis One 3-8
- Genesis Two 9-16
- Genesis Three 17-18
- Specialist 19-21
- System Detail 22

British Thornton ESF Ltd,
Prospect Works,
South Street,
Keighley,
West Yorkshire,
BD21 5AA
Tel: 08705 329 201
Fax: 01535 680 226
Web: www.british-thornton.co.uk





British Thornton

laboratory systems

Today's laboratory must be flexible and adaptable if it is to cope with the rapid advances of technology, and it follows that the demands of this volatile working environment places significant strains on both furniture and fittings.

Here at British Thornton we understand these demands, and our experience in precision engineering and craftsman cabinet-making since 1870 ensures fine quality furniture designed to improve efficiency and provide a safe and stimulating place of work.

There is however, nothing old fashioned about British Thornton!

As the projects shown in this brochure demonstrate, and as our portfolio of prestigious clients will testify, we are at the forefront of design innovation and excellence - investing significant sums of money in state-of-the-art machinery and an expansion of factory space.

For you to get the most from this wealth of experience and manufacturing know-how we offer a free planning and design service to help maximise the use of your available space and materials.

The service includes site surveys · CAD layouts · material samples and colour boards.

Delivery direct from the factory means our product arrives on site how and when you want it - meeting the most demanding main contractors' programme.

We employ our own expert and experienced fitting teams, supplemented as necessary by fully qualified tradespeople.



system profile

A no-nonsense, practical design, combining robust solid construction with simple lines and coved up flooring to create a clean and sterile environment. Rigid steel handles offer ease of access, while 'Trespa Toplab' work surfaces provide exceptional durability and a high resistance to chemicals.

Genesis
One



key features

- Economical
- Functional
- Robust
- Range of Finishes
- Co-ordinated
- Bespoke



“Where flexibility is of secondary importance to durability”



Genesis One

fixed pedestal systems

One of the UK's most widely used laboratory systems, the Genesis One Pedestal System is the ideal choice for situations where flexibility is of secondary importance to durability.

The robustly constructed bench tops are supported directly on top of the underbench units with no assistance from additional legs or supports.

For ease of access to services, the units all incorporate removable backs.





system profile

A robust and highly functional system available in a range of finishes, incorporating specialist areas and features such as instrumentation benches and special drainage troughs.

Genesis One

key features

- Economical
- Functional
- Robust
- Range of Finishes
- Co-ordinated
- Bespoke



Genesis One

fixed pedestal systems



Ideal for supporting heavy equipment on the work surface, the illustrated Genesis One fixed pedestal system brings clean design, fume cupboards, more efficient and flexible equipment positioning and co-ordinated services to the laboratory.

The system incorporates dropper boxes which support and clad service pipework from ceiling to worktop.

*“Brings clean design
and co-ordinated services
to the laboratory”*





system profile

Things have moved on since Henry Ford once famously said of his Model T: "You can have any colour you like, so long as it's black...."

Genesis One

key features

- Economical
- Functional
- Robust
- Range of Finishes
- Co-ordinated
- Bespoke



“Delivering exactly what you want”

Genesis One

fixed pedestal systems



Here at British Thornton we deliver exactly what you want – and our photograph shows a high quality design, colour co-ordinated with the fabric of our client's building.

In this case continuous metal handles (finger pulls) were epoxy powder coated to match the fume cupboard cills.

By utilising a fixed pedestal system this laboratory is able to incorporate knee spaces in pre-determined positions.

In our featured example the flooring “coves up” to the cabinet plinths, offering a more hygienic system.





system profile

Flexible and versatile, this robust, modular steelwork system, supports worktops on either a C frame or cantilever design.

In the installation shown the underbench units are mounted on large, robust castors for positioning anywhere, even over the protruding bottom leg of the C frame.



Genesis Two

key features

- Flexible
- Versatile
- Robust
- Range of Finishes
- Co-ordinated
- Bespoke

Genesis Two

cantilever system



Stylish, robust and practical this system incorporates British Thornton designed Duo steel leg frames – bringing elegance and distinction, as well as functionality, into the laboratory environment. The under bench units can easily be moved, interchanged or replaced.

*“Elegance,
Distinction and
Functionality!”*





system profile

A very effective design with clean design lines incorporating two-tier reagent shelving over island benches and adjacent write-up areas. Worktops are manufactured in solid grade laminate and service pipework is concealed within purpose-made dropper boxes.

Genesis Two

key features

- Hygienic
- Versatile
- Robust
- Range of Finishes
- Co-ordinated
- Bespoke
- Spillage Resistant



*“A perfect example
of our innovative design
approach”*

Genesis Two

cantilever system



A perfect example of our innovative design approach matched to manufacturing expertise – allowing us to create a system of the highest quality at a price which won't break the bank!

In addition to offering exceptional value the system allows the flexibility of fitting ancillary equipment – fridges, incubators, flammable cabinets and such like - under benches in lieu of cabinets.





system profile

Appropriate for categories of laboratories that demand cleaning and disinfecting of all areas.

This system fully copes with both requirements due to its flexibility, versatility and spillage resistant build quality.

Genesis
Two

key features

- Hygienic
- Versatile
- Robust
- Range of Finishes
- Co-ordinated
- Bespoke
- Spillage Resistant

Genesis Two

cantilever systems



In the example shown, the shelving above the peninsular benches is fabricated from solid grade laminate as are the 'flanking' panels.

The layout illustrated demonstrates the robustness of this particular design - based on solid grade laminate components.

The requirement was instigated by PFI funding demands for a high quality specification with a prolonged life cycle.



“A robust design instigated by PFI funding requirements for a high quality specification and high life cycle”



system profile

An extremely flexible system allowing unlimited selection of cabinet placement because of the absence of front legs.

The above illustration shows a University Teaching Laboratory with equidistant units located to suit student seating requirements.

Genesis Two

key features

- Flexible
- Versatile
- Robust
- Range of Finishes
- Co-ordinated
- Bespoke

*“Perfect environment
for a university teaching
laboratory”*

Genesis Two

cantilever systems



The moveable storage units have the facility to be locked into position.

Incorporating bench tops supported by a steel framework, the Genesis Two cantilever system is an alternative to the pedestal system.

Sink units are fixed in position and independent under bench units may be situated where desired. The under bench units can be easily removed, interchanged or replaced.





system profile

A system designed for situations where hygiene is of primary concern, Genesis Three allows complete floor cleaning – quickly and easily. Worktops are supported by a steel framework beneath which the units are suspended, allowing both ease of repositioning and cleaning.

Genesis Three

key features

- Hygienic
- Versatile
- Robust
- Range of Finishes
- Co-ordinated
- Bespoke
- Spillage Resistant

“Absolutely perfect for research and development environments!”

Genesis Three

suspended systems



The hardwearing bench tops are supported on a steel framework ('C' frame, 'H' frame or cantilever) built to withstand the heavy loadings of the modern laboratory.

Under bench units are suspended from the metalwork and may be easily moved or repositioned.

Absolutely perfect for laboratories and analytical environments!





system profile

Though perhaps familiar with our bespoke major projects, you may not be aware of our bespoke items, for example:-

- Write up areas fabricated from laboratory furniture components.
- Splash protection in wash-up areas.

Bespoke Design

key features

- Hygienic
- Versatile
- Robust
- Range of Finishes
- Co-ordinated
- Bespoke
- Spillage Resistant





Specialist

bespoke design solutions

Bespoke items shown on this page are:-

- Ventilated sink workstation.
- Hygiene/Eyewash station
- Vented chemical storage cupboards with extraction (the example illustrated is at the end of a bank of fume cupboards).
- Curved deonstration station in Corian.
- Double sided pull-out storage wall.



system profile

British Thornton promise to design, produce, deliver and install quality tailor-made furniture to the highest specification.

Our total commitment ensures that every client always benefits from exceptional standards of service keeping British Thornton at the forefront of quality laboratory design.

Bespoke Design

key features

- Hygienic
- Versatile
- Robust
- Range of Finishes
- Co-ordinated
- Bespoke
- Spillage Resistant



pedestal systems

The most economical and robust system for laboratory furniture. Under-bench storage units provide the support for the worksurface. Access to service voids are facilitated by removable backs to the units and removable panels.

Plinths/skirtings can be covered with a matching floor finish to create a clean environment.



cantilever systems

As the worktop is supported on a steel framework, the under-bench units can be positioned as required.

Under-bench units can be mobile on castors, semi-mobile on skids or semi-permanent by locking the units into designated positions.

Access to the service void is via the removable panel attached to the steel framework.

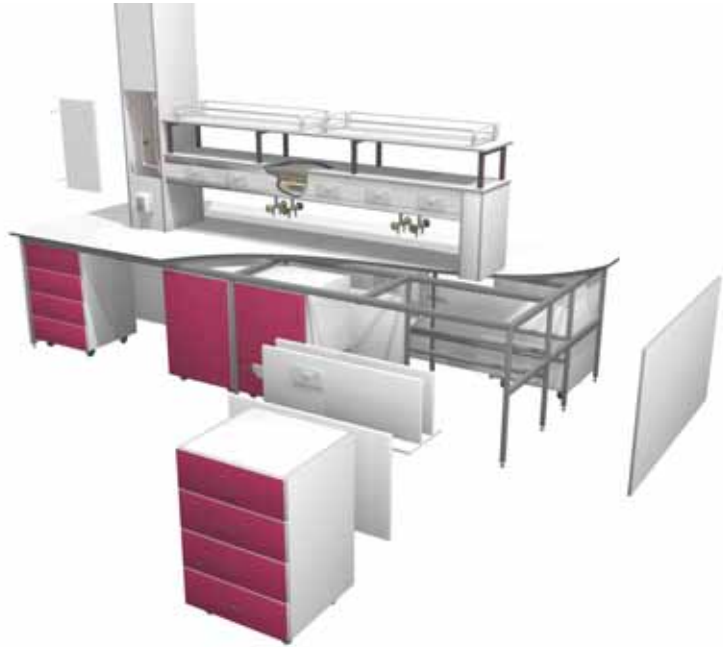

suspended systems

The steelwork frame supports the worktop and also allows the under-bench units to be suspended from the frame beneath the worktop.

Suspended systems offer a high degree of flexibility with units positioned as required.

Clear visibility beneath the under-bench units make cleaning easier - another benefit of the suspended system.





Laboratory furniture for:

Universities

Pharmaceuticals

Chemicals

Healthcare

Medical Schools

Public Sector Laboratories

Environment Agency

MOD

DEFRA

Police Forensic

Public Health

Engineering

Food and Drink

Utilities

